

TRAC Receptacle fixing screws, nuts

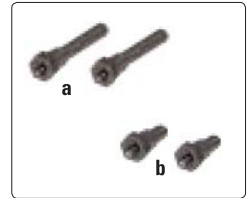
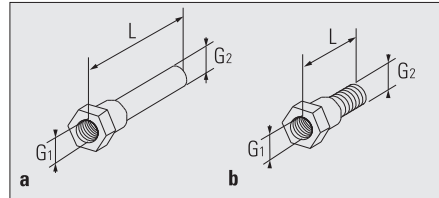

Material: Stainless steel

Item number	L [mm]	G ₁ thread	G ₂ thread	picture
SUB21	21.3	M3 inside	M2.5 inside	a
SUB11	11.0	M3 inside	M3 outside	b

Hex. nut to SUB11: SUM6KTM3

Screws for TRAC D-SUB covers

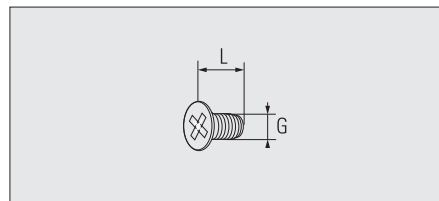

Material: Stainless steel

Item number	Description	G thread	L [mm]
SUCHM2.5x5	Thread-cutting countersunk cross-head screw	M2.5	5.0

Screws for TRAC Buscoupler covers

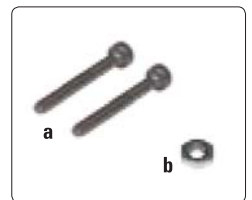
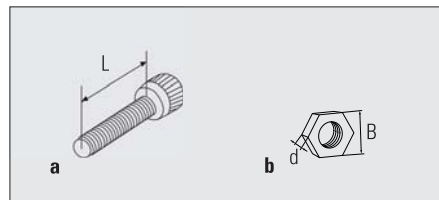

Material: Stainless steel

Item number	Description	thread	L [mm]	B [mm]	d [mm]	picture
FSCI6KTM2.5x16	Screws for Buscoupler covers	M2.5	16.0	-	-	a
SUM6KTM2.5	Locknut for Buscoupler covers	M2.5	-	4.8	2.1	b

Square washers for mounting strip assemblies

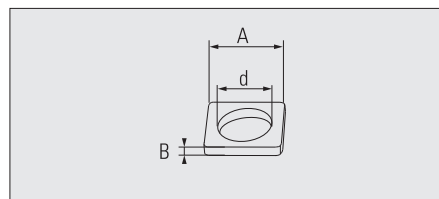

Item number	A [mm]	d [mm]	B [mm]	Material
SUUQ1.0	6.0	4.1	1.0	Stainless steel
SUUQ1.5	6.0	4.1	1.5	Stainless steel, galvanised